

Tenda



All for better networking.

PH9

AV1000 Wi-Fi Powerline Adapter Kit

<http://www.tendacn.com>

Link
More



PH9

AV1000 Wi-Fi Powerline Adapter Kit

Product Description

PH9 Double 1000Mbps provides faster network for your entertainment. With the new generation Broadcom Powerline chipset and Homeplug AV2 technology, the transmission speed of PH9 can be up to 1000Mbps. And its Gigabit Ports is 10 times better than 100M ports, which is the real Gigabit network for your entertainment.

Selling Points

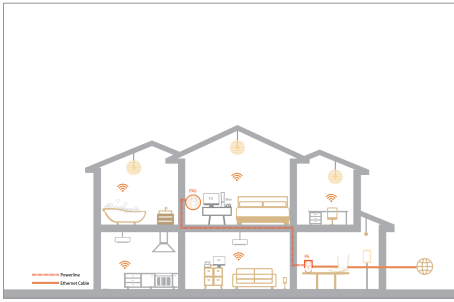

Extend Your Network at Home

With HomePlug AV2 protocol, PH9 kit transmit reaches the speed of up to 1000Mbps, completely resolving the signal dead zoon by power line, to provide a high quality Wi-Fi connection.

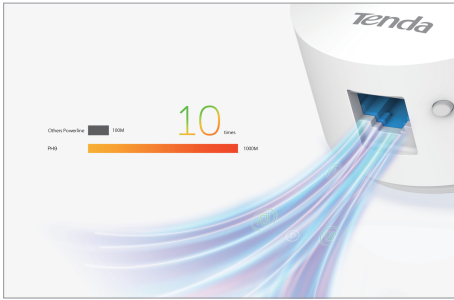

Gigabit Ethernet Port for Fast Data Transfer

Utilizing all gigabit ethernet ports, PH9 KIT allows you to connect appliances to the Internet at high speeds and ensures the smooth transmission of ultra 4K video streaming.

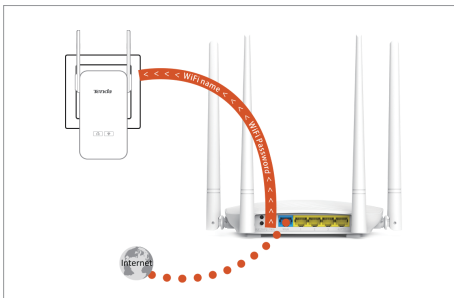

Plug and Play

With Wi-Fi cloning technology, Wi-Fi cloning can be finished just by pressing "WPS" button on router and "Wi-Fi" button on PA6.

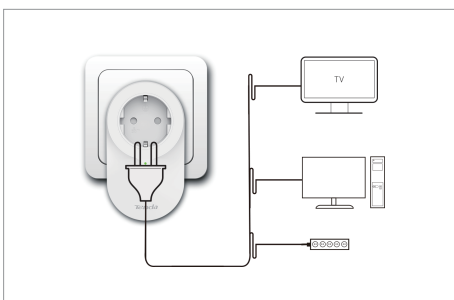

Extra Power Socket for Additional Appliances

Designed with a power socket that allows as high as 16A* current, PH9 can supply power to TV, game console or desktop computer. The built-in noise isolation filter reduces interference from the electrical appliance plugged to the power socket of PH9. (*Power output of up to 16A is suitable for electrical appliances to be connected)



Power Saving Mode for 85% Less Energy Consumption

PH9 enters power saving mode when no device is connected to reduce energy consumption by over 85% subject to the operating environment.

Technical Specifications

Basic information

View of product



| | |
|--------------|------------------------------------|
| Product Name | AV1000 Wi-Fi Powerline Adapter Kit |
|--------------|------------------------------------|

| | |
|-------|-----|
| Model | PH9 |
|-------|-----|

Hardware Features

| | |
|-----------|---|
| Interface | Wi-Fi Powerline Extender: 2 * 10/100/1000 Mbps RJ45 Powerline Adapter: 1 * 10/100/1000 Mbps RJ45 |
|-----------|---|

| | |
|--------------|--|
| Antenna Type | 2 * External 3dBi omni-directional antenna |
|--------------|--|

| | |
|---------|-----------------------|
| Antenna | Two external antennas |
|---------|-----------------------|

| | |
|--------|--|
| Button | Wi-Fi Powerline Extender: 1 * Pair, 1 * Wi-Fi Clone/switch, 1 * Reset Powerline Adapter: 1 * Pair/Reset |
|--------|--|

| | |
|---------------|---|
| LED indicator | Wi-Fi Powerline Extender: 1 * Powerline, 1 * Wi-Fi Powerline Adapter: 1 * Power, 1 * Powerline, 1 * Ethernet |
|---------------|---|

| | |
|-------------|---------------------------|
| Power Input | AC100 ~ 240V 50/60Hz 0.1A |
|-------------|---------------------------|

| | |
|-------------------|---|
| Power Consumption | Wi-Fi Powerline Extender: 8.9W(Maximum) Powerline Adapter: 3.2W(Maximum) |
|-------------------|---|

| | |
|------------|---|
| Dimensions | Wi-Fi Powerline Extender: 120mm*63mm*42mm(L x W x H) Powerline Adapter: 108.5mm*61.5mm*45mm(L x W x H) |
|------------|---|

Software Features

| | |
|--------------------|---|
| Wireless Standards | HomeplugAV2 IEEE 802.3, IEEE 802.3u, IEEE 802.3ab IEEE802.11b/g/n |
|--------------------|---|

| | |
|-----------|--|
| Frequency | Powerline: 2-86MHz Wireless: 2.4GHz |
|-----------|--|

| | |
|-------------------|--|
| Power Consumption | Poweline: 1000Mbps Wireless: 2.4GHz Up to 300Mbps |
|-------------------|--|

Others

| | |
|---------------|--------------|
| Certification | CE, FCC、RoHS |
|---------------|--------------|

| | |
|-----------|----------|
| Plug Type | US、EU、UK |
|-----------|----------|

| | |
|------------------|--|
| Package Contents | 1 * AV1000 Gigabit Passthrough Powerline Adapter 1 * AV1000 2-Port Gigabit Wi-Fi Powerline Extender 1 * Quick Installation Guide |
|------------------|--|

| | |
|------------------|---|
| | 1 * Cat5e Ethernet Cable |
| Environment | Operating Temperature: 0°C ~ 40°C(32°F ~ 104°F) |
| | Storage Temperature: -40°F ~ 158°F (-40°C ~ 70°C) |
| | Operating Humidity: 10% ~ 90% RH non-condensing |
| | Storage Humidity: 5% ~ 90%RH non-condensing |
| Related Products | PH3, PH 5, PH6, PH10 |

SHENZHEN TENDA TECHNOLOGY CO.,LTD.

Tenda Technology Bldg.Int' IE-City,
#1001 Zhong Shan Yuan Rd.,Nanshan District,Shenzhen China.

E-mail:support@tenda.com.cn
Tel:+86-755-2765 7098
Fax:+86-755-2765 7178
PC:518055

